

Building Guide

Grant, Nebraska

Gary Beckler
308-352-6101

Single Family Residential Patio Covers & Carports

How to Use this Guide

1. Complete this Building Guide by filing in the blanks on page two, and indicating which construction details will be used.

2. Provide a Floor Plan (site plan) showing dimensions of your project or addition and its relationship to existing buildings or structures on the property and the distance to existing property lines.

3. Fill out a building permit application.

The majority of permit applications are processed with little delay. The submitted documents will help determine if the project is in compliance with building safety codes, zoning ordinances and other applicable laws.

This handout was developed as a basic plan submittal under the 2015 Uniform Codes. It is not intended to cover all circumstances. Check with your City of Grant Building Inspector for additional requirements.

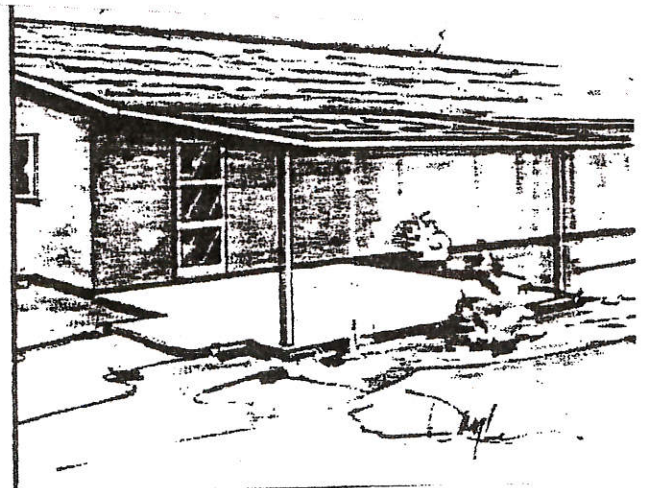

Single Family Residential Patio Covers & Carports

Directions

Address: _____

1. Fill in the blanks with dimensions and materials which will be used to build the structure. Please print legibly.

2. Indicate in the check boxes which details from page 3 will be used. You must however, keep at least two sides of the carport open to conform to the building code requirements.

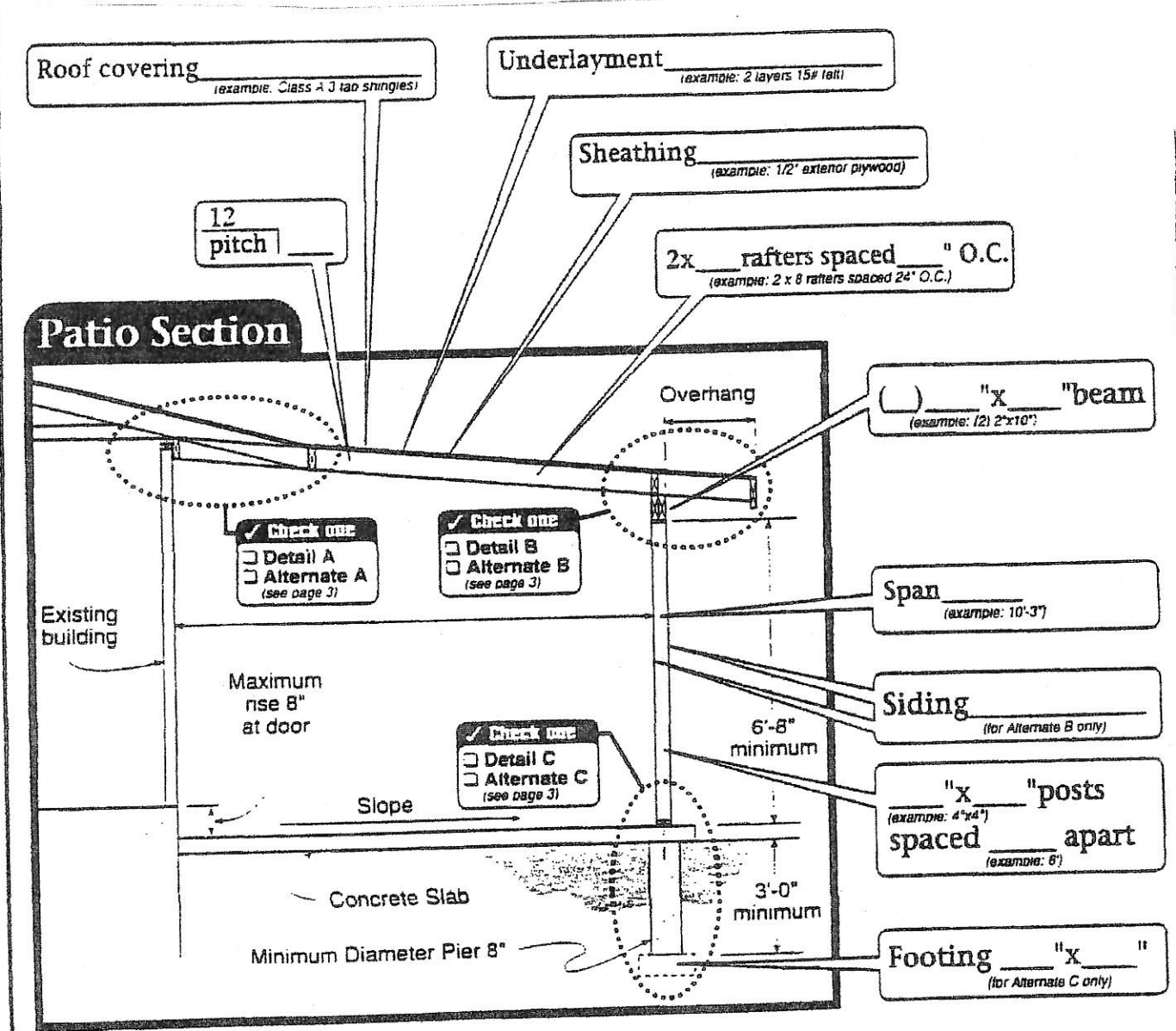

Single Family Residential Patio Covers & Carports

Detail A

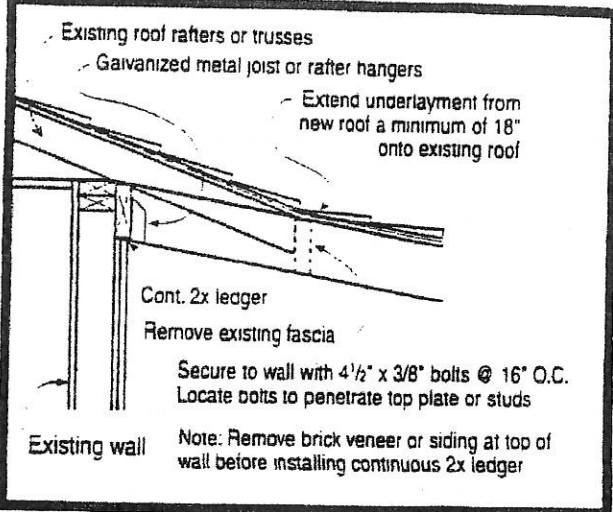

Alternate Detail A

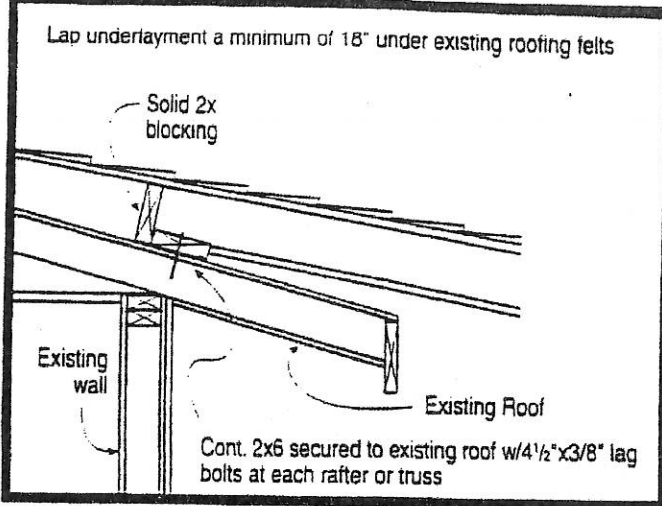

Detail B

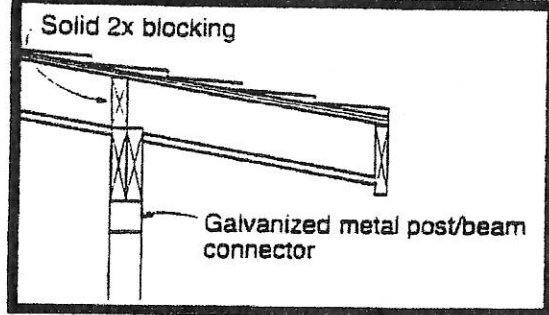

Alternate Detail B - One Hour Wall

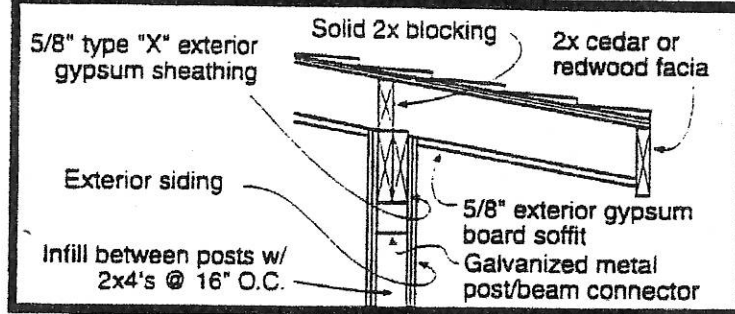

Detail C

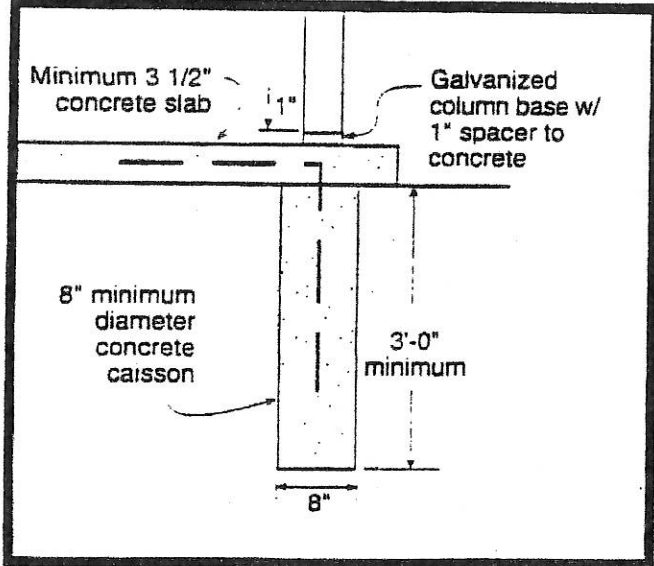

Alternate Detail C - One Hour Wall

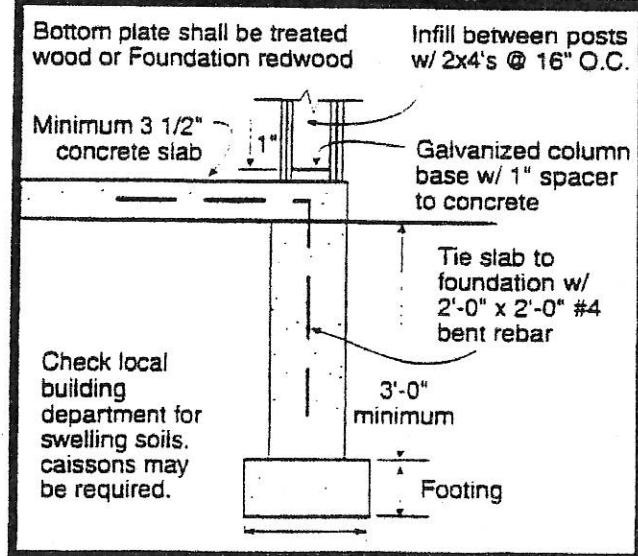

APPLICATION AND PERMIT FOR BUILDING OR STRUCTURE

CITY OF GRANT, NEBRASKA

Date applied _____

Type of permit: BUILDING FENCE SIGN RESIDENTIAL NON-RESIDENTIAL

OWNER INFORMATION

Name: _____ Mailing Address: _____

Phone Number: _____ Physical Address: _____

CONTRACTOR INFORMATION

Name: _____ Mailing Address: _____

Phone Number: _____

PROJECT INFORMATION

Address of Building Site: _____ Lot Size: _____

Legal Description of Lot: _____

Approximate Cost of Improvements: _____ Current Zoning: _____

Description of construction: _____

Size of structure or addition:

Main Level _____ sq. ft. _____ 2nd Story _____ sq. ft. _____

Basement _____ sq. ft. _____ Other _____ sq. ft. _____

Attached Garage _____ sq. ft. _____ TOTAL SQUARE FEET _____

Location on lot: _____ ft. from front property line or curb _____ ft from rear or alley

Side yard set backs: _____

Principal type of structure: Wood Frame Structural Steel Masonry Other

Water Tap required: YES or NO. Size _____ Sewer tap required: YES or NO

Electrical Service desired: YES or NO. Size _____ Tap fees paid by _____

State Electrical permit required: _____ By Licensed electrician _____ or Owner _____

BUILDING INSPECTOR / RESTRICTIONS: _____

Note: Applicants agree that owners must adhere to building restrictions over any and all easements and that all work related to this project be performed in accordance with the provisions of the International Code Council (ICC) and the City of Grant building codes and zoning ordinances and any restrictive covenants.

Applicant name _____ Permit Fee \$ _____

Applicant Signature _____ Paid Check # _____

Approved _____ Date _____

Building official